

BED / STRETCHER 1

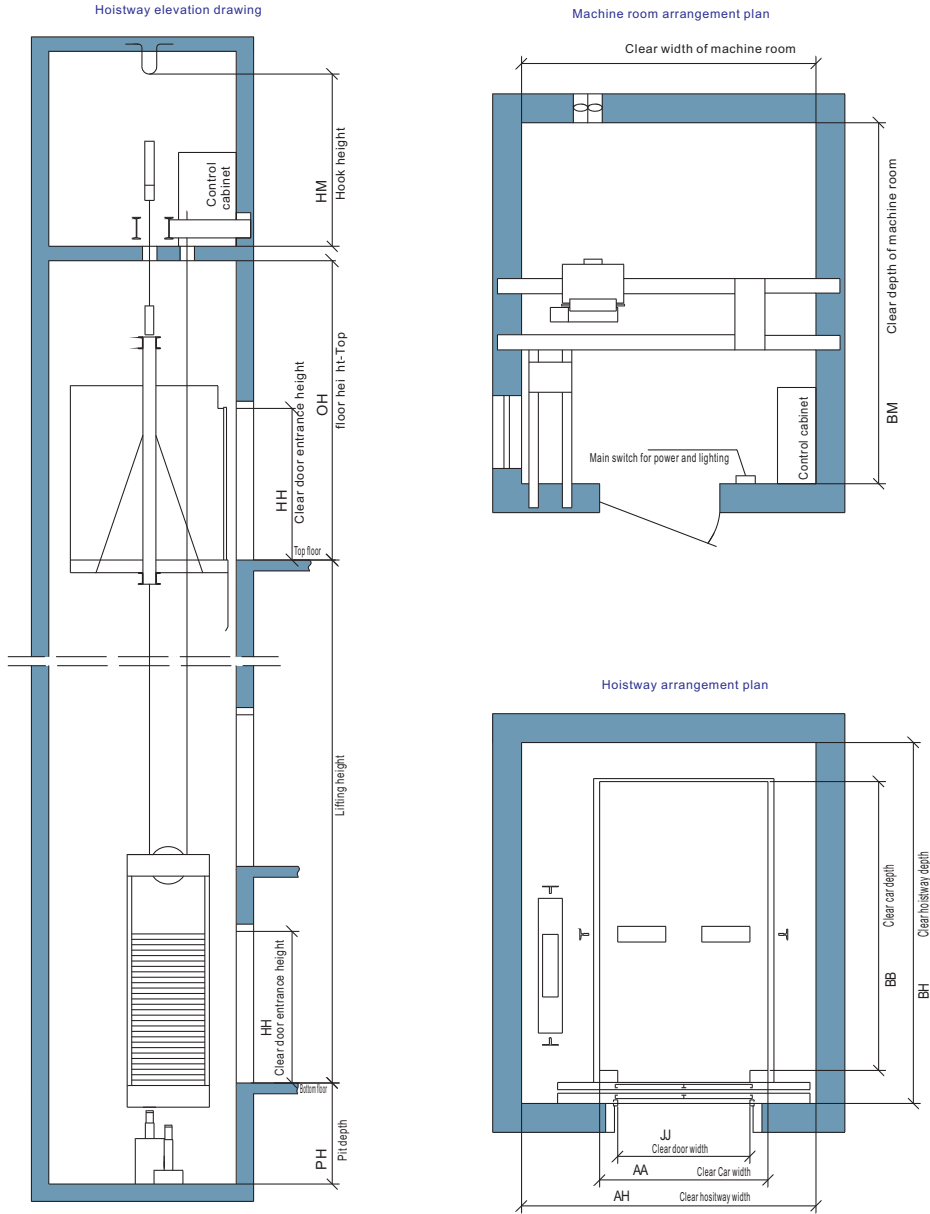

Main technical parameters (gearless)

rated capacity rated number of passengers (kg/P)	rated speed s/m()	car size		door size		hoistway dimensions				machine room dimensions			
		mm(AA)	mm(BB)	mm(JJ)	mm(HH)	mm(AH)	mm(BH)	mm(PH)	mm(OH)	mm(AM)	mm(BM)	mm(HM)	
1250/16	1.0	1400	2000	Center-opening 1100	1200	2100	2400	2600	≥ 1400	≥ 4300	3000	4000	≥ 2000
	1.6								≥ 1650	≥ 4400			
	1.75			Side-opening	2100	2400	3000	≥ 1400	≥ 4300				
	2.0							≥ 1650	≥ 4400				
1600/21	1.0	1400	2400	Center-opening 1100	1200	2100	2400	3000	≥ 1400	≥ 4300	3000	4000	≥ 2000
	1.6								≥ 1650	≥ 4400			
	1.75			Side-opening	2100	2400	3040	≥ 1400	≥ 4300				
	2.0							≥ 1650	≥ 4400				